

R.74W. R.73W. R.72W. LARIMER BOULDER R.71W. R.70W. COUNTY COUNTY R.69W

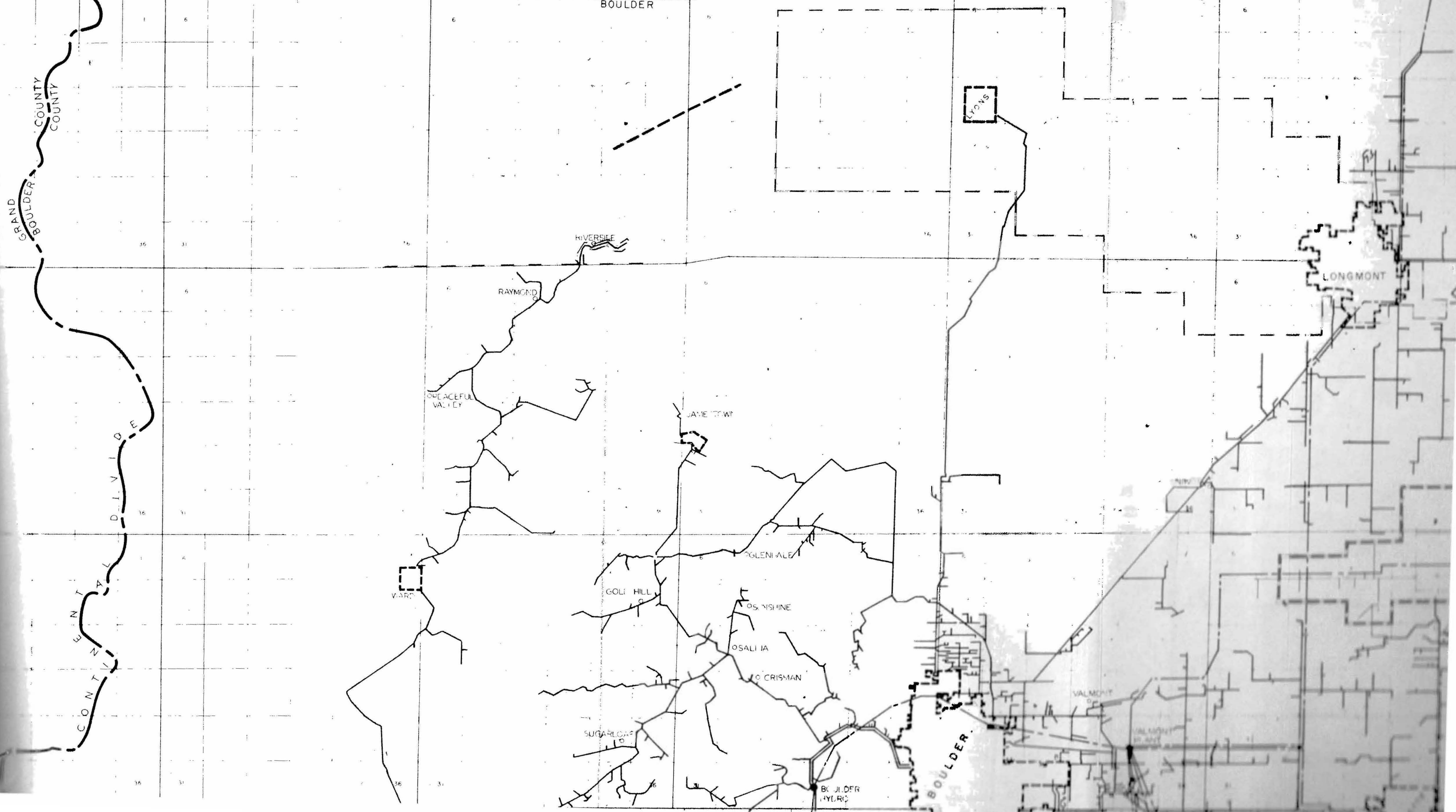

GRAND BOULDER COUNTY COUNTY  
CENTRAL DIVIDE

LARIMER BOULDER

LYONS

RIVERSIDE

RAYMOND

PEACEFUL VALLEY

JAMESTOWN

GLENDALE

GOLF HILL

OSKISHINE

OSALIA

CRISMAN

SUGARLOAF

BOULDER

VALMONT

LONGMONT

BOULDER VALLEY

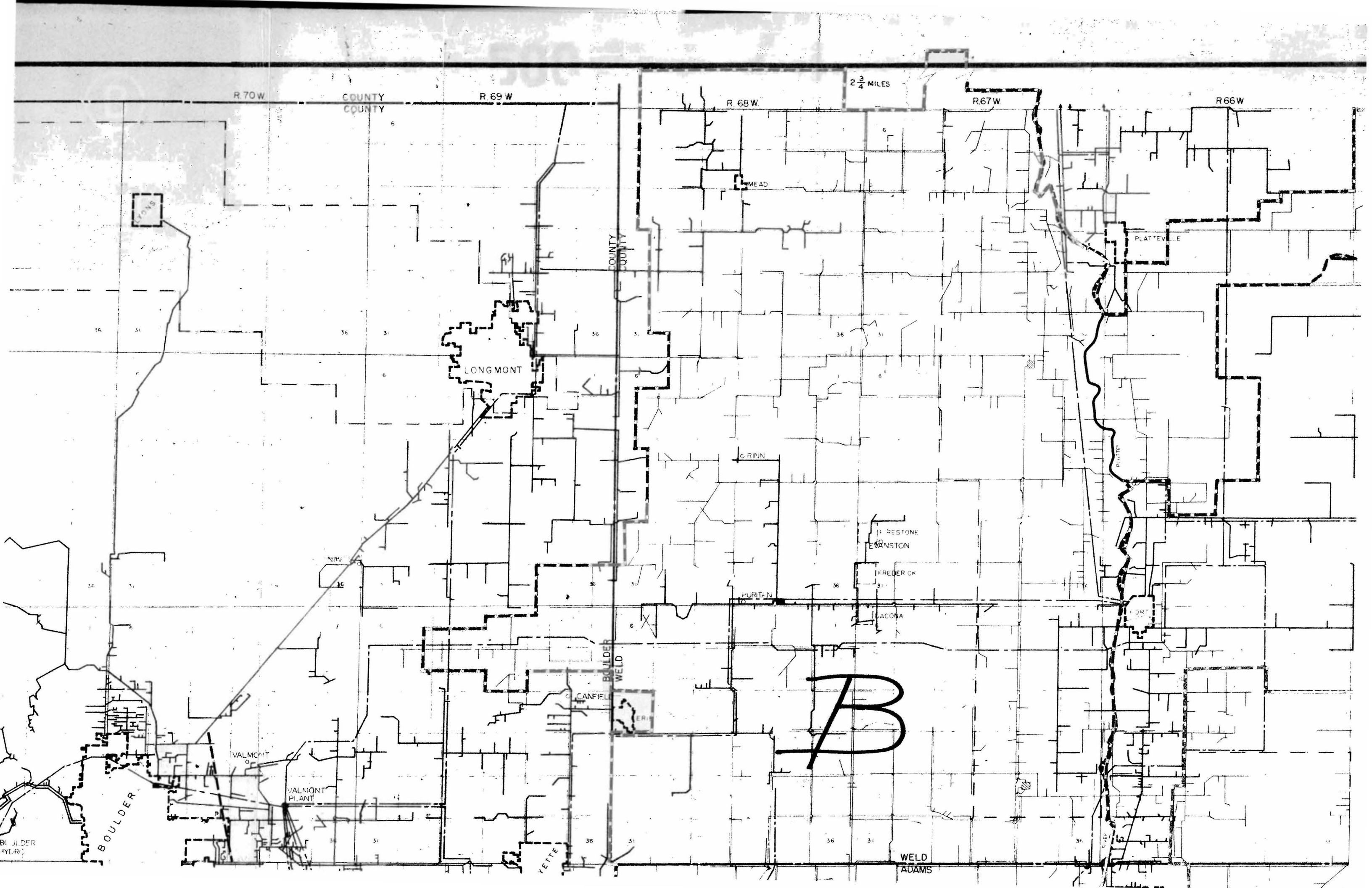

R 70W

BOULDER COUNTY

R 69W

R 68W

2 3/4 MILES

R 67W

R 66W

LYONS

LONGMONT

GRINN

RESTONE  
EVANSTON

FREDER CK

MACONA

PLATTEVILLE

PLATTE RIVER

CANFIELD

BOULDER COUNTY  
WELD COUNTY

B

VALMONT

VALMONT PLANT

YETTE

WELD  
ADAMS

BOULDER  
HYDRO

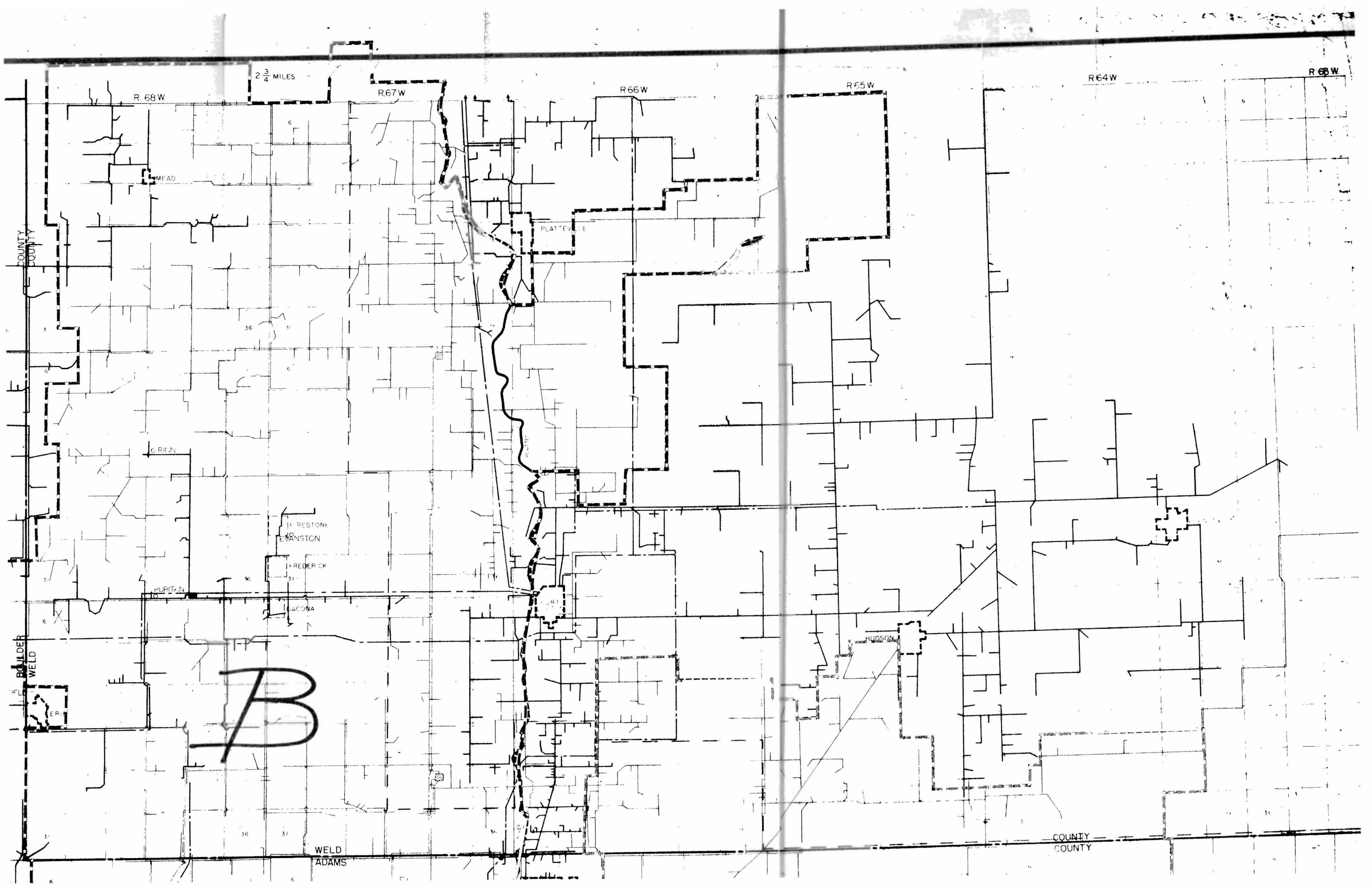

2 3/4 MILES

R. 68W

R. 67W

R. 66W

R. 65W

R. 64W

R. 63W

COUNTY  
COUNTY

BOULDER  
WELD

WELD  
ADAMS

COUNTY  
COUNTY

MFAD

PLAT'VILLE

GRIFFIN

PURITAN

RESTON  
EVANSTON

FREDERICK

LACONA

HUDSON

**B**

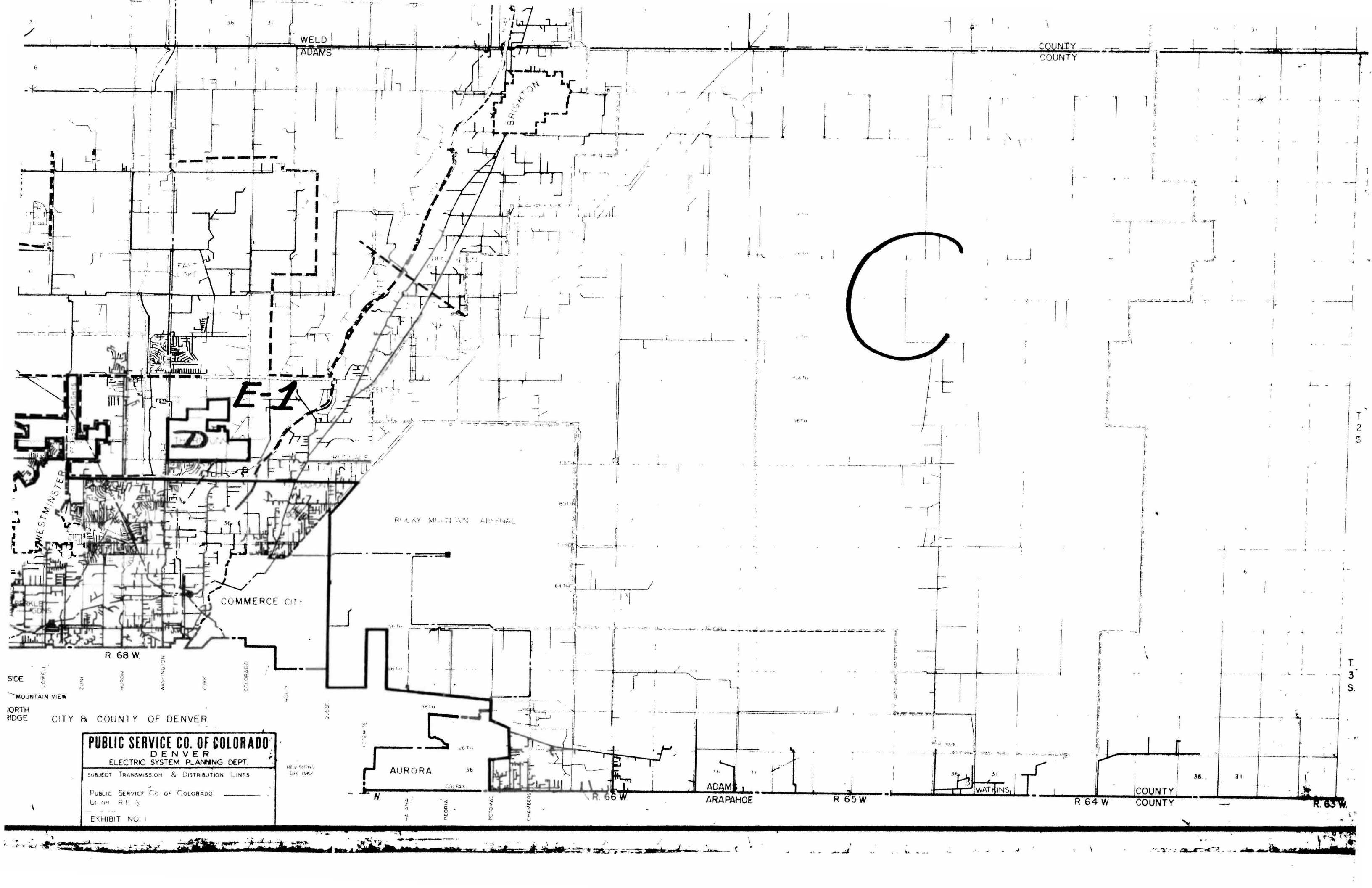

WELD  
ADAMS

COUNTY  
COUNTY

BRIGHTON

FAVOR  
LAMP

E-1

D

ROCKY MOUNTAIN ARSENAL

COMMERCE CITY

R. 68 W.

SIDE  
MOUNTAIN VIEW  
NORTH RIDGE  
CITY & COUNTY OF DENVER

**PUBLIC SERVICE CO. OF COLORADO**  
DENVER  
ELECTRIC SYSTEM PLANNING DEPT.  
SUBJECT TRANSMISSION & DISTRIBUTION LINES  
PUBLIC SERVICE Co. of Colorado  
Union REA  
EXHIBIT NO. 1

REVISIONS  
DEC 1962

AURORA

ADAMS  
ARAPAHOE

WATKINS

COUNTY  
COUNTY

R. 63 W.

N

PEORIA

POTOMAC

CHAMBERS

R. 66 W.

R. 65 W.

R. 64 W.

36

31

T. 2 S.

T. 3 S.

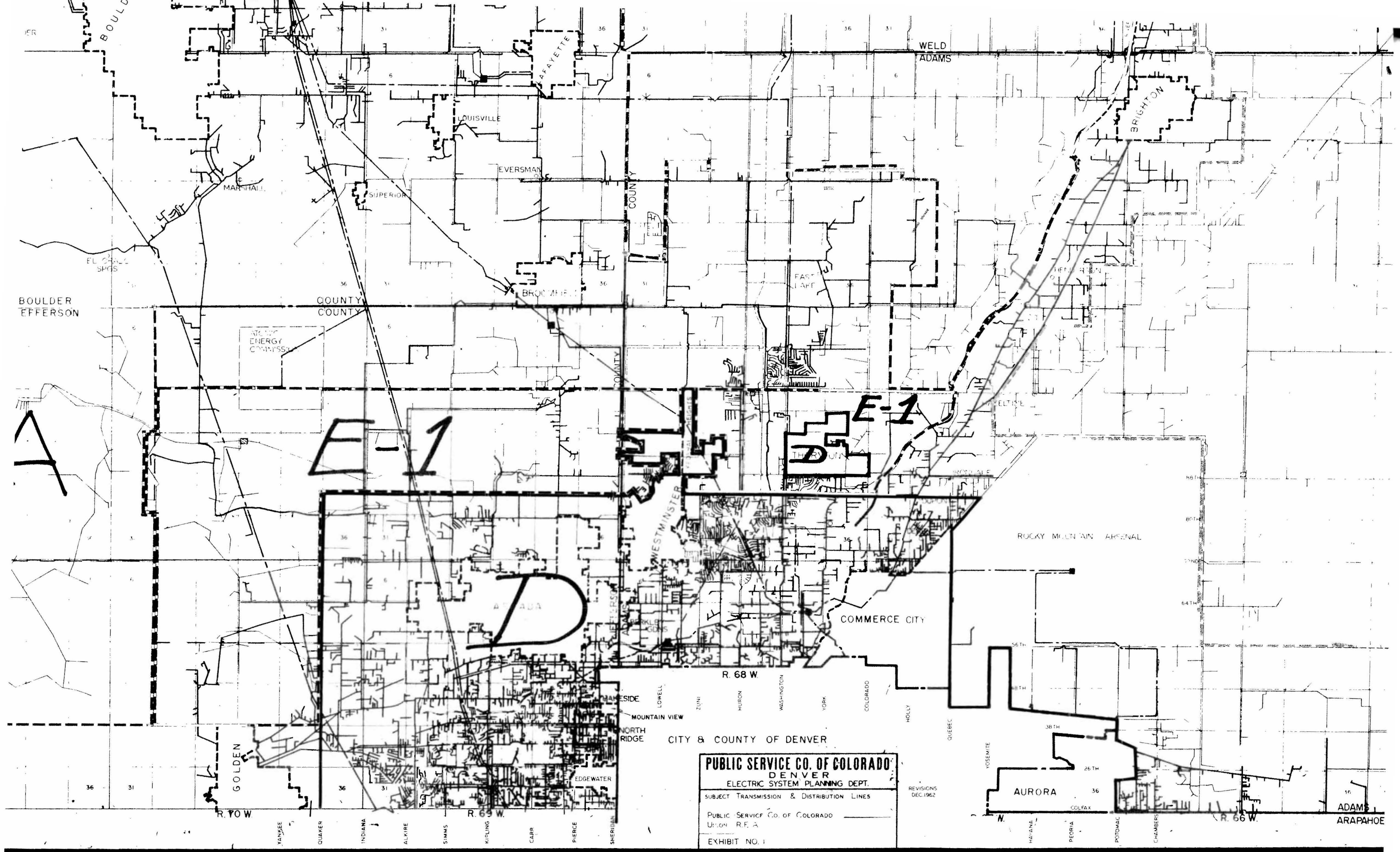

BOULDER  
EFFERSON

A

E-1

E-1

D

**PUBLIC SERVICE CO. OF COLORADO**  
**DENVER**  
 ELECTRIC SYSTEM PLANNING DEPT.  
 SUBJECT TRANSMISSION & DISTRIBUTION LINES  
 PUBLIC SERVICE Co. OF COLORADO  
 UNION R.F.A.  
 EXHIBIT NO. 1

REVISIONS  
 DEC. 1962

ADAMS  
 ARAPAHOE

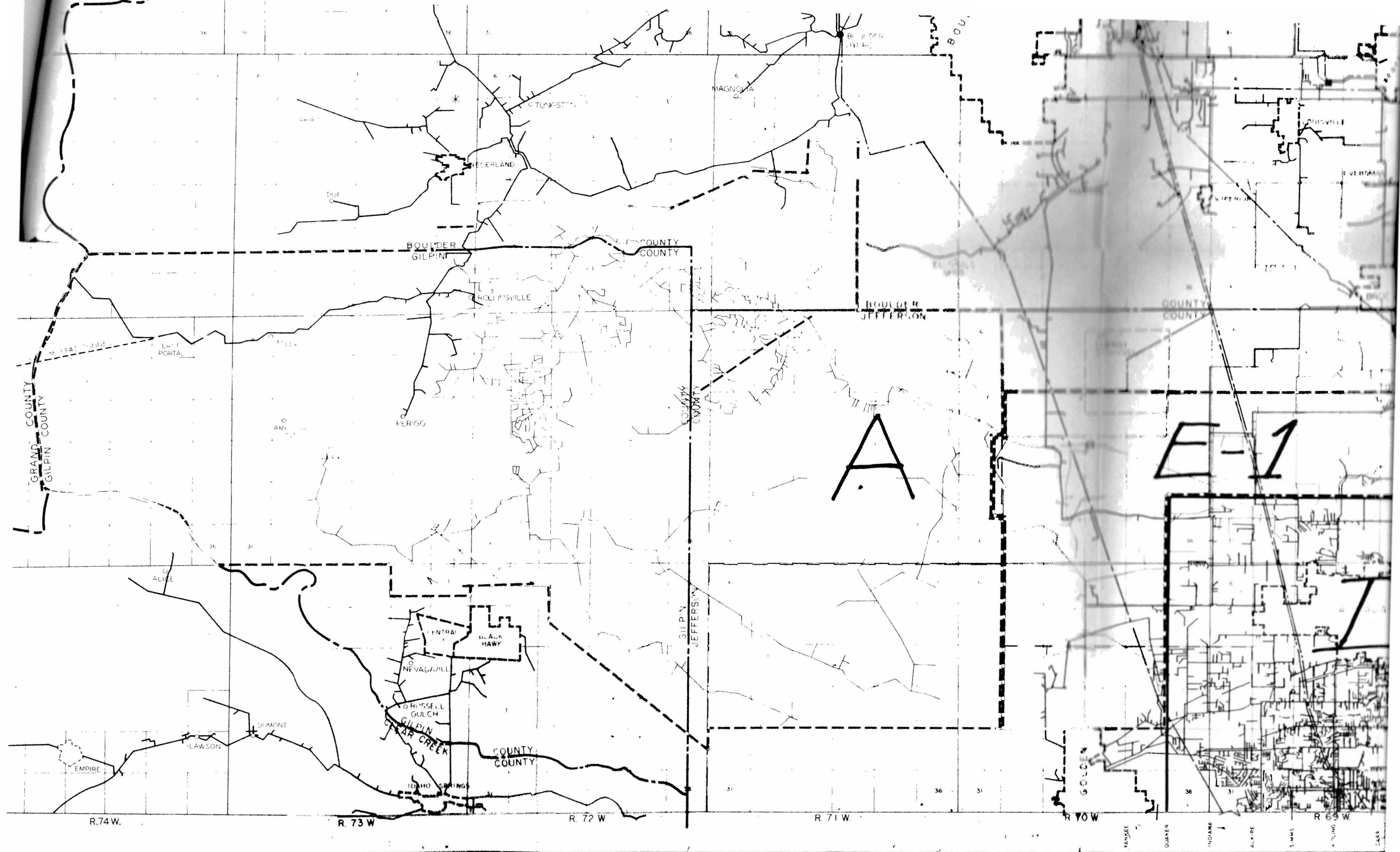

A

E-1

R. 74 W.

R. 73 W.

R. 72 W.

R. 71 W.

R. 70 W.

TANSEE QUAKER INDIANA ALKIRE SIMMS KING CASE